



SALAD SPINNER SERIES

ELECTRIC SALAD SPINNER EM 98 WITH TIMEOUT

Ref : E003.T



DESCRIPTION

- Certified to NSF / ANSI 2-2009 : **North American Health standard certifying that the product meets strict requirements of quality and safety.**
- Ideal for spinning salads effortlessly for a better yield.
- Fast and efficient, it respects the product's fragility.
- Heavy duty construction for an intensive daily use.
- Outside container, top and inner basket in Polypropylene (Food-safe plastic).
- Antibacterial incorporated (biocide treated), complies with the HACCP requirements.



ACCESSORY

Ref. AC019



Stabilising base : base with the suction pads. For increased stability.



WITH TIMEOUT
(RUNNING TIME 1 MINUTE)

USE

Indispensable to prepare high volume of salads.

Capacity : 20 L

Recommended for 3 - 5 lettuce heads.

MAINTENANCE

Before cleaning, unplug the wringer EM 98.

Wash the tray and basket with a water jet.

Clean the cover with a damp sponge.

Do not immerse the lid in water.

Do not put in a dishwasher.



TECHNICAL DATA

| | |
|---------------|--------------------------------|
| SPEED | 500 tr/mn |
| TOTAL HEIGHT | 630 mm |
| DIAMETER | 430 mm |
| OUTPUT MAX | 110-120V - 220-240V 50-60Hz |
| VOLTAGE | 200 W |
| ACTUAL WEIGHT | 8,3 kg |

www.dynamicmixers.com

Dynamic - 518 rue Léo Baekeland BP57 - 85290 Mortagne sur Sèvre

Tel : +33 (0)2 51 63 02 72 • E-mail : export@dynamicmixers.com

Follow us on social networks!



TECHNICAL SHEET

Ref E003 / E003.T

Parts list Code

| | |
|--|--------|
| SELF LUBRICATING RING | 0603 |
| HANDLE SCREW | 0720 |
| HANDLE | 0782 |
| FRICTION WASHER | 0787 |
| MOTOR HOUSING SCREWS | 079917 |
| MOTOR SCREW | 079929 |
| HEXAGON SOCKET SET SCREW M6X30 | 079980 |
| HAEXAGONAL SERRATED FLANGE NUT M6 | 079981 |
| SMALL GEAR MOTOR SHAFT | 0831 |
| PUSH SWITCH | 0905 |
| SWITCH PROTECTOR | 0905.1 |
| STRAIN RELIEF 220-240 V | 0950 |
| STRAIN RELIEF 110-120 V | 0950.1 |
| POWER CORD (220-240V) | 0966 |
| POWER CORD 110-120 V | 0967 |
| POWER CORD (ENGLAND) | 0973 |
| POWER CORD (AUSTRALIA) | 0974 |
| OUTSIDE BASKET + AXLE | 2801 |
| COVER WITHOUT SMALL COVER, HANDLE & GEAR | 2804 |
| OUTSIDE BASKET AXLE | 2810 |
| AXLE | 2814 |
| MOTOR HOUSING FOR SALAD DRYER WITHOUT TEMPO (WITH LABEL) | 3001 |

Ref E003 / E003.T

Parts list Code

| | |
|--|----------|
| MOTOR HOUSING FOR SALAD DRYER WITH TEMPO | 3001.1 |
| BIG GEAR | 3002 |
| GEAR HOUSING PROTECTOR | 3003 |
| MOTOR 220-240V (+ CAPACITOR) | 3004 |
| MOTOR 110-120 V (+ CAPACITOR) | 3004.1 |
| MOTOR PLATE | 3005 |
| SMALL GEAR | 3006 |
| AXLE, BIG GEAR | 3007 |
| CAPACITOR 220-240 V | 3008 |
| CAPACITOR 110-120 V | 3008.1 |
| COMMAND CIRCUIT WITH TEMPORIZATION | 3009 |
| SALAD SPINNER COMPLETE COVER 220-240V | 3010 |
| SALAD SPINNER COMPLETE COVER 110-120V | 3010.1 |
| COMPLETE COVER FOR SALAD SPINNER WITH TEMPORIZATION 220-240V | 3010.T |
| COMPLETE COVER FOR SALAD SPINNER WITH TEMPORIZATION 110-120V | 3010.T.1 |
| 220-240V MOTOR WITH SHAFT | 3024 |
| 110-120V MOTOR WITH SHAFT (FROM SERIAL NUMBER 19/00179) | 3024.1 |
| BUCKET 20L | P2802 |

E003.T

P2802

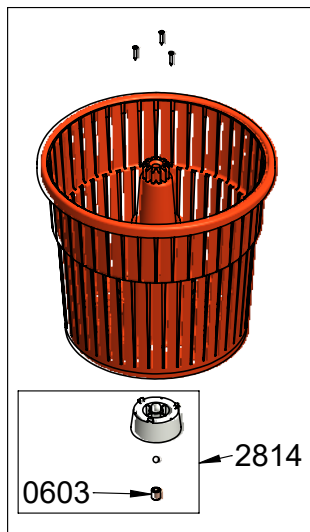

2801

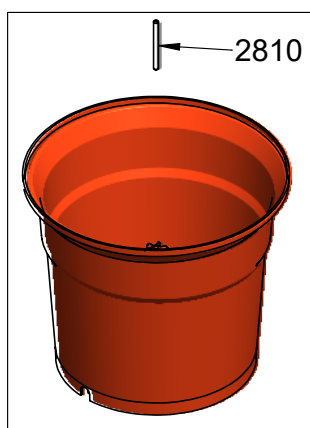

3010.T-3010.T.1

